

# DATASHEET

## TWISTERS EARPLUGS

PROTECTION AGAINST NOISE



**Twisters® Cord 6441**

### CHARACTERISTICS

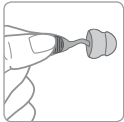

#### Easy insertion

Large handle for easy insertion & removal



#### Hygienic

No rolling necessary - plugs stay hygienic clean and can be used more than once



#### Comfortable

Easy in-ear fit adjustment due to unique multi-curved stem



#### Cord

Allows the plugs to be worn around the neck



#### 100% PVC-free

All Moldex products and packaging are completely free from PVC

Twisters® Cord



#### Soft foam pod

Soft foam pod for a comfortable, snug seal

Twisters® Trio Cord



#### Washable

Plugs made of soft durable material - washable and hygienic



#### Soft

Soft and flexible flanges



#### PocketPak

Comes with handy PocketPak storage container



**Twisters® Trio Cord 6451**

### ATTENUATION DATA

The Moldex range of hearing protection products passes the EN352-2 minimum attenuation requirements set out in the table below.

#### Minimum attenuation requirement (dB)

Freq. (Hz)	63	125	250	500	1000	2000	4000	8000
APV <sub>f</sub> (dB)	-	5.0	8.0	10.0	12.0	12.0	12.0	12.0

#### Twisters® Cord (6441)

Freq. (Hz)	63*	125	250	500	1000	2000	4000	8000
M <sub>f</sub> (dB)	32.9	32.9	30.6	33.4	34.5	37.7	40.6	45.7
s <sub>f</sub> (dB)	5.2	5.2	5.0	4.9	4.6	4.2	3.3	4.6
APV <sub>f</sub> (dB)	27.7	27.7	25.6	28.5	29.9	33.5	37.3	41.1
Size: 10-14	H = 34 dB		M = 30 dB	L = 28 dB		<b>SNR = 34 dB</b>		

\*EN ISO 4869-2:1995

#### Twisters® Trio Cord (6451)

Freq. (Hz)	63	125	250	500	1000	2000	4000	8000
M <sub>f</sub> (dB)	31.1	29.7	33.3	33.2	37.5	34.9	36.3	43.0
s <sub>f</sub> (dB)	5.3	4.7	5.2	4.8	4.1	4.6	4.5	3.6
APV <sub>f</sub> (dB)	25.7	25.0	28.1	28.4	33.4	30.4	31.7	39.4
Size: 8-12	H = 32 dB		M = 31 dB	L = 29 dB		<b>SNR = 33 dB</b>		

M<sub>f</sub> = Mean sound attenuation

s<sub>f</sub> = Standard deviation

APV<sub>f</sub> = Assumed protection value

### MATERIALS

Twisters® are made of the following materials:

**Twisters® Cord (6441):** PUR, PC, TPE

**Twisters® Trio Cord (6451):** PC, TPE

### WEIGHT (per pair)

**Twisters® Cord:** 2.5 g      **without Cord:** 1.3 g

**Twisters® Trio Cord:** 2.8 g

# DATASHEET

## TWISTERS EARPLUGS

PROTECTION AGAINST NOISE



### CERTIFICATION

The Moldex range of hearing protection products meet the requirements of EN352-2 and are CE-marked in accordance with the requirements of European Directive 89/686/EEC. Responsible for type examination (Article 10): "Twisters® Cord"/"Twisters® Trio Cord" FIOH (0403) Helsinki (FIN).

### TESTING

The earplugs of the Moldex Hearing Protection range have been tested to EN352-2 and fulfil all requirements of the relevant categories.

#### Ignitability

The earplugs shall not ignite upon application of a heated rod, nor continue to glow after the removal of the heated rod.

#### Construction

All parts of the earplugs are designed and manufactured so that they are not liable to cause physical damage to the wearer when fitted and used according to the instructions.

### INSTRUCTION FOR USE

- The products must be used in accordance with the relevant national legislation.
- Warning: disregarding the instructions for use and fitting instructions for these products can affect the product efficiency in protecting against noise.
- The products should be stored in a cool, dry environment.
- The products may be adversely affected by direct contact with certain chemical substances (e.g. aromatic hydrocarbons).
- The products are reusable provided the hygiene of the product is maintained between each use. Clean with mild soap and water.
- Allow the plugs to fully dry after cleaning/disinfection.

### INSTRUCTIONS FOR FITTING

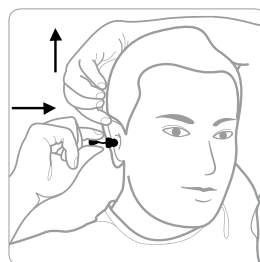

1. Reach above the head and pull the ear gently upwards. Slide the plug into the ear canal.

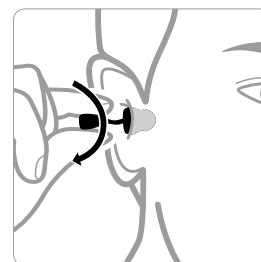

2. Rotate the plug slightly whilst inserting to find your fit.

### TWISTERS® CORD ONLY

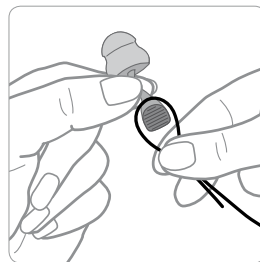

To attach cord, form a loop, position around groove at handle.

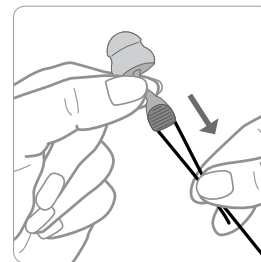

Pull down to lock in place.

### INFO

For help on selection and training please contact us. We offer a wide range of training packages and support material.

MOLDEX-METRIC AG & Co. KG  
Unit 9, Glaisdale Point  
Off Glaisdale Drive, Bilborough  
Nottingham. NG8 4GP

Tel.: +44 (0)115 985 4288  
Fax: +44 (0)115 985 4211  
info@uk.moldex-europe.com  
www.moldex-europe.com