

Clean Bench

HCB-900V HCB-1300H
HCB-1300V HCB-1600H



Main Applications

A professional localized air purification equipment suitable for pharmaceuticals, medical and health, scientific research laboratories of universities and colleges, photoelectric/microelectronics manufacturing and other fields

Qingdao Haier Biomedical Co.,Ltd.

No.280 Feng Yuan Road, High-tech Zone,
Qingdao, 266109, P.R. China
Tel: +86-0532-88935593
Website: www.haiermedical.com



Haier Biomedical
International



Haier Biomedical
International



@haiermedicalint



@haierbiomedicalint



Haier Biomedical
International

Product advantages

- Manufactured with an internationally branded moisture-proof and flame-retardant glass fiber high efficiency particulate air filters (HEPA), which ensures a filtration efficiency of 99.99% or above for particles of 0.3um or above
- The air cleanliness conforms to Class 5 of the ISO14644.1 Standard, and is better than Class 100 cleanliness requirements
- With the industry's first pre-cleaning function: namely pre-cleaning the workspace before sample treatment so as to further improve the protection of samples
- Adopting built-in lighting to prevent the eyes from being exposed to the fluorescent lamp and thus avoids eye strain

One-key operation, convenient and secure:

- With a timed UV lamp turnoff function, it is adjustable between 0 and 99 minutes
- Interlock function, avoiding the risk of mis-operation
- With the lighting lamp and UV lamp interlock function; the UV lamp can only be lit when the lighting lamp is off. After the fluorescent lamp turned on, the UV lamp will be turned off immediately so that the risk of mis-operation can be reduced to zero

Friendly design

Ergonomic design, making work easier

- The table top is 800mm high from the ground, which is suitable for both standing and sitting operations, relieving any fatigue issues and makes work easy

Delay start of UV sterilization to avoid UV damage

- After the UV lamp switch is pressed down, there will be sound and light signals to remind the operators to leave immediately and the UV lamp will light up after a delay of 10 seconds to protect the operator from ultraviolet radiation
- The UV sterilization timed start function ensures less down time of usage and higher efficiencies from the user

Split type chassis for easy installation and movement

- With separated chassis, cabinet body and universal casters with adjustable feet for easy movement and fixation

Product dimensions

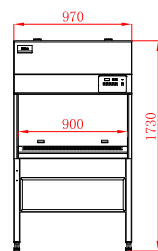

HCB-900V

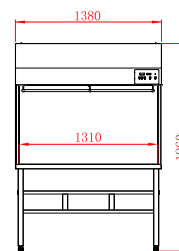
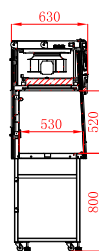

HCB-1300H

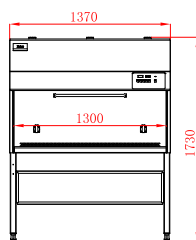
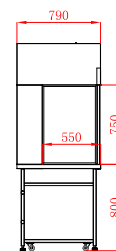

HCB-1300V

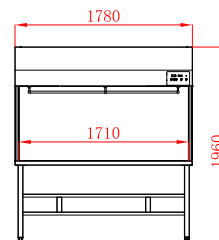
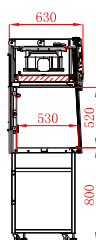

HCB-1600H

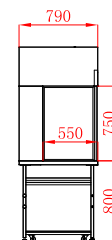

Specifications

| Model | | HCB-900V | HCB-1300V | | HCB-1300H | | | HCB-1600H | |
|-----------------------------------|-----|---------------------------|---------------------------|---------------|---------------------------|--------------|---------------|---------------------------|--------------|
| Flow Type | | Vertical | Vertical | | Horizontal | | | Horizontal | |
| Voltage/Frequency(V/Hz) | | AC 220/50 | AC 220/50 | AC 115V/60 | AC 220/50 | AC 220/60 | AC 115V/60 | AC 220/50 | AC 220/60 |
| Power(W) | | 1200 | 1200 | | 350 | | | 350 | |
| Vibration Amplitude (UM) | | 2 | 2 | | 2 | | | 2 | |
| Exhaust Filter Typical Efficiency | | H13 HEPA, 99.99%@0.3um | H13 HEPA, 99.99%@0.3um | | H13 HEPA, 99.99%@0.3um | | | H13 HEPA, 99.99%@0.3um | |
| Average Velocity (M/S) | | 0.2-0.4 | 0.2-0.4 | | 0.2-0.4 | | | 0.2-0.4 | |
| Fluorescent Lamp Intensity(Lux) | | ≥300 | ≥300 | | ≥1000 | | | ≥1000 | |
| Net/Gross Weight (approx.) | kg | 115/145 | 145/171 | | 145/175 | | | 165/214 | |
| | lbs | 254/319 | 320/376 | | 319/385 | | | 363.7/471 | |
| Sound Level(dB(A)) | | 58 | 58 | | 61 | | | 61 | |
| Internal Dimensions (W*D*H) | mm | 900*530*520 | 1300*530*520 | | 1310*550*750 | | | 1710*550*750 | |
| | in | 35.4*20.9*20.5 | 51.2*20.9*20.5 | | 51.6*21.7*29.6 | | | 67.3*21.7*29.6 | |
| External Dimensions (W*D*H) | mm | 970*630*1730 | 1370*630*1730 | | 1380*790*1960 | | | 1780*790*1960 | |
| | in | 38.2*24.8*68.1 | 53.9*24.8*68.1 | | 54.4*31.1*77.2 | | | 70.1*31.1*77.2 | |
| Packing Dimensions (W*D*H) | mm | 1105*745*1280 | 1505*745*1280 | | 1465*940*1350 | | | 1865*940*1370 | |
| | in | 43.5*29.3*50.4 | 59.3*29.3*50.4 | | 57.7*37*53.2 | | | 73.4*37.0*53.9 | |
| Cleanliness Classification | | ISO 14644.1 Class 5 | ISO 14644.1 Class 5 | | ISO 14644.1 Class 5 | | | ISO 14644.1 Class 5 | |
| Container Load(20'/40'/40'H) | | 15/33/33 | 10/25/25 | | 8/16/16 | | | 6/12/12 | |
| Certification | | CE,TUV,NMPA(CFDA) | CE,TUV,NMPA(CFDA) | | CE,TUV | | | CE,TUV,NMPA(CFDA) | |